

JL Prestressed related products series

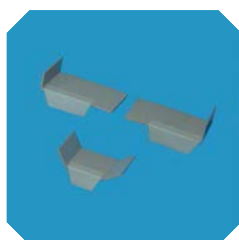

J L Form1



J L Tanbudar1

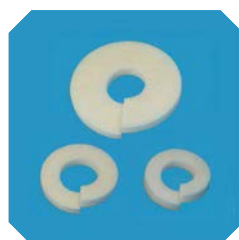

Sheath Seal2

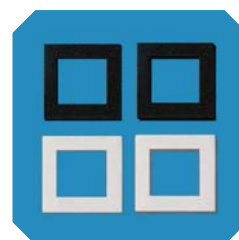

A P Seal2



GC Cap3



J L Filler 3

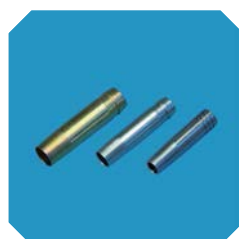

Hose Joint4

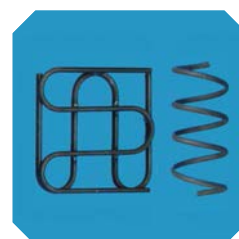

Spiral/Grid 5

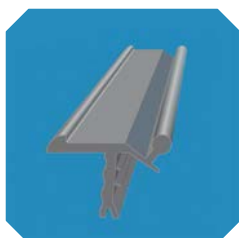

Norodomekun5

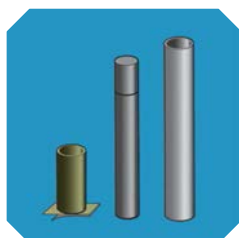

Component for cylindrical form of bridge 6

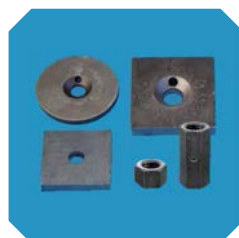

AnchorPlate/PCnut7

JL Form (Mold for PC girder made by resin) / JLTanbudar (component to support JL form)

Product features

- Be able to execute in a short working time.
- Made by high density resin that can avoid rust.
- The shape of rib can avoid cross-section loss.
- The rib can avoid cross-section loss.
- To make efficient work by using tanbu.
- Reduce production cost by mass production.
- Have wide range of size that can allow most of digits.

● JL Form

W30,50,70,9010 type
(joint type)

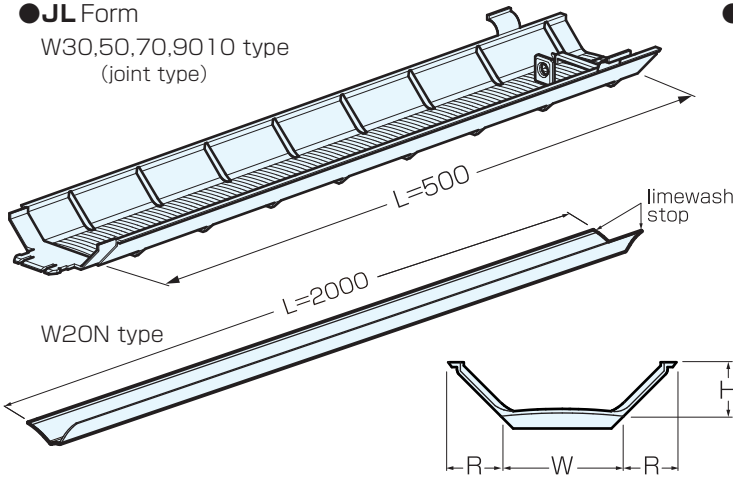

● JLTanbudar (both right and left)

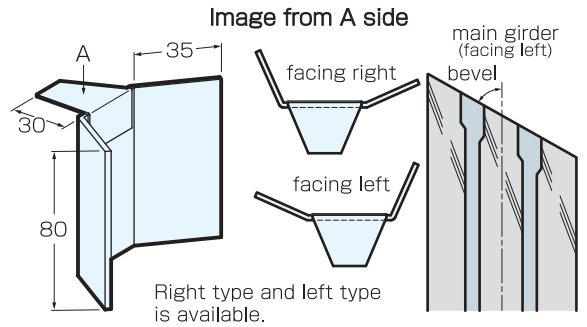

How to install.

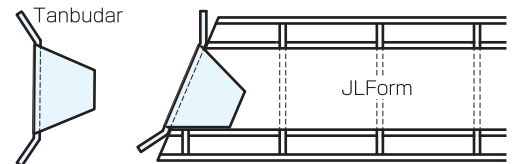

Set a Tanbudar after cut JL Form.

■ JL Form・JLTanbudar specification

Part code	Length between girder	W	R	H	L	(m)/ carton	(unit:mm)			
							Tanbudar (bevel 60°-90° right&left)			
W-20N	10~25	20	25	20	2000	160	*20-60°	*20-70°	*20-80°	*20-90°
W-30	26~35	30	20	20	500	120	30-60°	30-70°	30-80°	30-90°
W-50	36~55	50	21	22.5	500	120	50-60°	50-70°	50-80°	50-90°
W-70	56~75	70	20	20	500	80	70-60°	70-70°	70-80°	70-90°
W-9010	76~100	95	24.5	25	200 (*200x5)	60	*90-60°	*90-70°	*90-80°	*90-90°

- JL form W-9010 packed per 1m unit.
- When ordering, please specify the length of JL form, the degree and right or left for tanbudar.
- It is available per request as for the above 100mm length between girder.

■ WATER CUTOFF TAPE for JLForm (Isobutylene-isoprene rubber)

Part code	Size	case pack/ carton
WATER CUTOFF TAPE	1mm×25mm×15m	48pcs

- Tight Frame (available for length between girder of above 100mm)
It is available to request plan for tight frame that required for concrete placement of T type / I type / Hollow girder.

Applications

〈Example of using JLForm〉

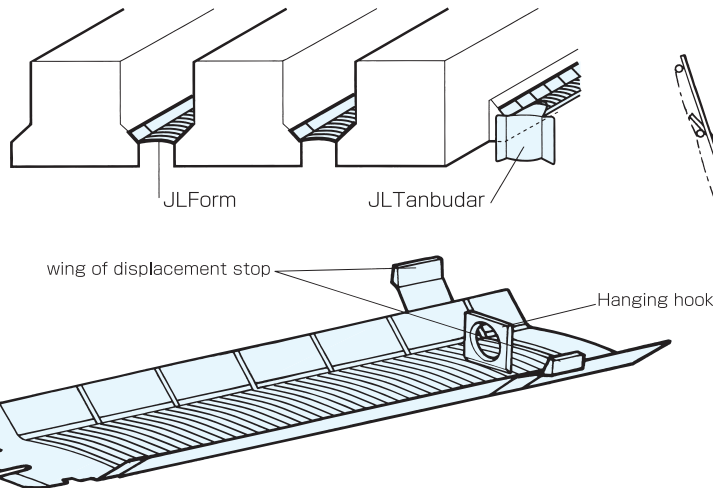

〈Example of using Tight Frame〉

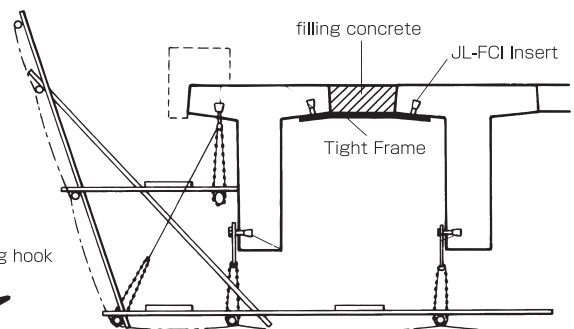

Sheath Seal PAT.

Product Features

- Sheath seal is the product to stop limewash from Sheath. Compare to vinyl tape or mortar, Sheath seal is made by sponge which is very right and easy to install. Also, the cost is lower than others.
- Material : ポリエチレンフォーム

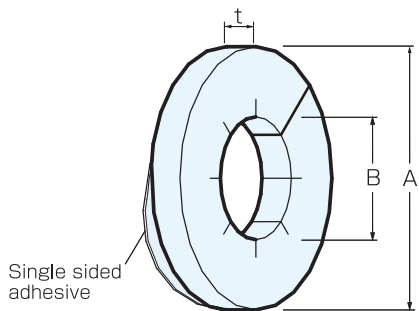

Product name	Specification			Diameter of sheath	inventory
	t	A(φ)	B(φ)		
C-0631	10	60	31	30.5	◎
C-0735	10	70	35	35	◎
C-0848	10	80	48	49	◎
C-1026	10	100	26	25.5	※
C-1035	10	100	35	30.5	◎
C-1070	10	100	70	69	◎
C-11090	10	100	90	89	◎

◎ Standard inventory, ※ production per order.

How to Install

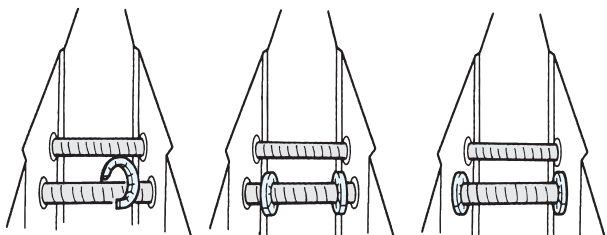

Example of use

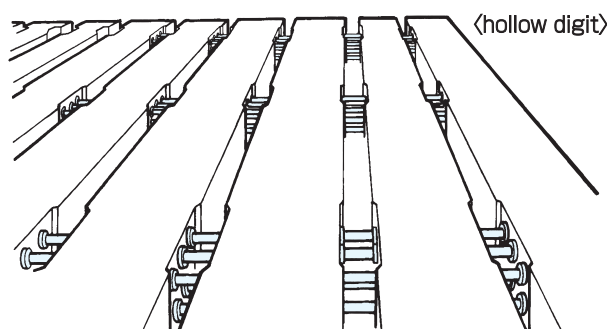

AP Seal

Product Features

- The product made by urethane foam that enable to prevent anchor plate to turn around, also have them stop limewash.
- One sided adhesive that can install anchor plate at prescribed place.
- Price is very competitive.
- Material : urethane foam

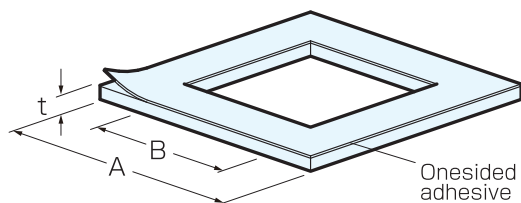

Product name	Specification			case pack
	A	B	t	
S-2	100	60	2	1000
S-5	100	60	5	1000

How to Install

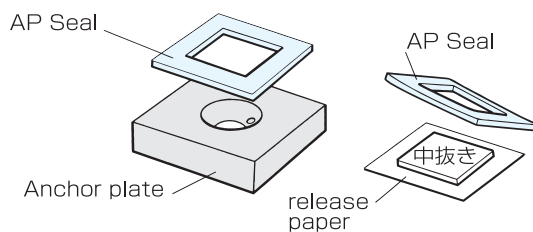

When install the anchor plate after concrete placement, it may produce empty air spot between anchor plate and concrete surface, so using urethane packing to prevent limewash.

Example of use

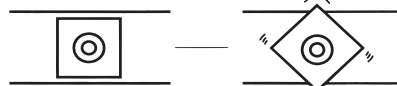

<Solution by using AP seal>
When you use existing seal products, they are made by resin material so it may turn into liquid base that made lubricating effect so that the anchor plate turns around. You can prevent that effect by using AP seal.

GC Cap

Product Features

- Used as protection cap for PC single strand.
- Protect the fixing part by resin material with rust prevention.
- Mentioned as standard material by Japan Prestressed concrete contractors association.
- Competitive price and high cost benefit performance.
- Enable to reduce the working time. (grout immediately after tension work)
- Using with reinforcement ring enables effective work of high pressure injection.

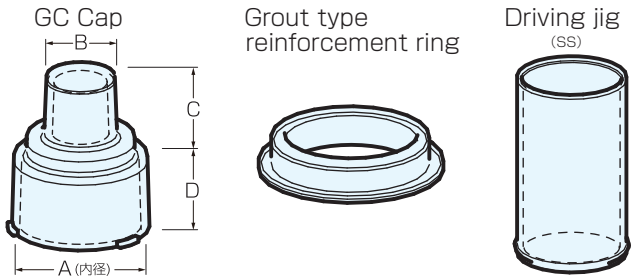

product name	part code	grip diameter (φ)	stranded wire diameter (φ)	specification				Reinforcement ring (grout type)	driving jig
				A(φ)	B(φ)	C	D		
GC Cap	GC-1	40	12.4 12.7	40	19	30	25	N/A	—
	GC-2A	45(A)	15.2	45	21	30	25	N/A	—
	GC-2B	45(B)	15.2	48	21	30	25	N/A	—
	GC-18	50	17.8	50	29	35	30	R-18	—
	GC-18-CCLJ	50.8	17.8	50	29	35	30	R-18	GC-18 GC-19 GC-22
	GC-19	55	19.3	55	29	35	30	R-19	—
	GC-22	65	21.8	65	32	40	35	R-22	—
	GC-29-80	80	28.6	82	40	40	40	R-29	—
	GC-29-CCLJ	82	28.6	84	40	40	40	R-29	GC-29

* : Please use JL driving jig specially made for GC Cap.

Example of use

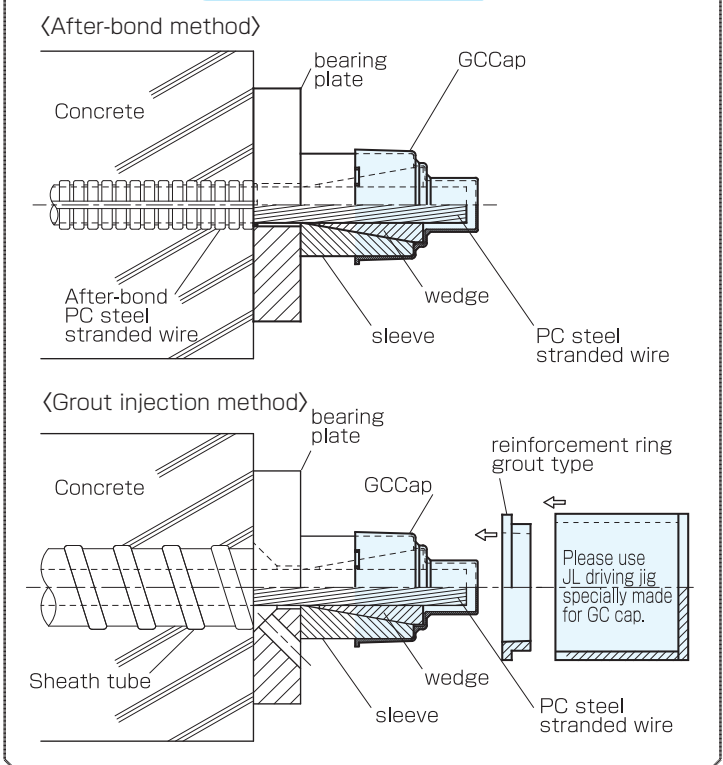

JL Filler

Product Features

- Two-component filler for GC Cap.
- Packed by 500g for easy handling.



■ Reference for quantity

GC Cap	Qty/pack
GC-18	20pcs
GC-18 CCLJ	20pcs
GC-19	20pcs
GC-22	15pcs
GC-29-80	10pcs
GC-29 CCLJ	10pcs

How to Use



① The white filler and black filler is separated by a center. The total weight of the filler is 500g.



② Hold the center part of both White part (main component) and black part (curing agent) by both side, pull them diagonally to peel off.



③ Rub the pack by hand until it changes concrete color.



④ Inject the filler to tip of GCCap. (50g for GCCap 28.6type)



⑤ Driving the GCCap that injected the filler into the inner part of fixing part. Please work quickly as the working life is short.

HoseJoint (Pipe to connect with grout hose of anchor plate)

Product features

- This is the joint pipe to connect securely with high pressure grout hose to grout hole of anchor plate to enables the high level grout injection work.
- Hammer the hose joint pipe into grout hole in order to fix securely.
- There is no leakage at joint part even by high pressure injection.

(Conventional Problem)
So far, we connect hose directly into grout hole of anchor plate, but because of recent rise of injection pressure, the hose sometime come out.

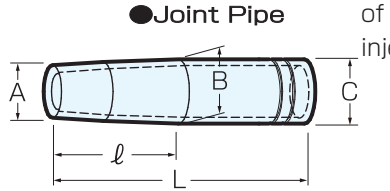
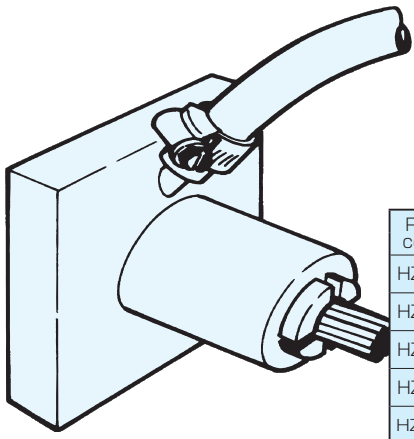

Part code	grout hole(ϕ)	specification					inventory
		A(ϕ)	B(ϕ)	C(ϕ)	L	l	
HZ-10	10.3	9.8	12.0	12.0	50	25	*
HZ-12	12.3	11.5	12.7	11.5	55	17	◎
HZ-15	15.3	14.7	15.9	14.6	60	20	◎
HZ-19	19.3	19.0	21.7	19.0	60	16	*
HZ-25	25.4	25.0	27.2	25.0	70	15	*

Surface treatment: Electrogalvanizing
◎: Standard inventory * : Production per order

Grout hose

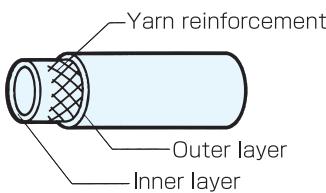

Part code	Color	Length (m)	Joint Pipe	inventory
grout hose ϕ 12/18	clear, red, blue, green	100	HZ-12	Non standard inventory
grout hose ϕ 15/22	clear, red, blue, green	100	HZ-15	Non standard inventory
grout hose ϕ 19/26	clear, red	50	HZ-19	Non standard inventory
grout hose ϕ 25/33	clear	50	HZ-25	Non standard inventory

Proof Pressure : 20kgf/cm²

Special anchor plate (Order made product)

Implantable anchor plate (w/pipe)

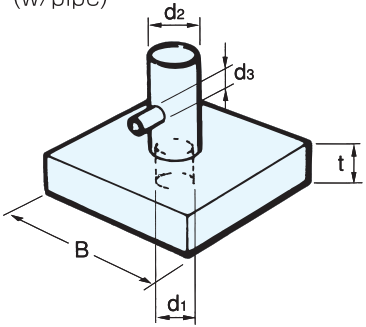

Nominal diameter	B	t	d ₁	d ₂	d ₃
17	90	19	20	27.2	
19.3	120	24	24	27.2	
21.8	135	28	29.5	34	12.7 (13.8)
23	120	24	27	34	
26	135	28	30	38.1	
33	165	32	36	42.7	

Oblique type anchor plate

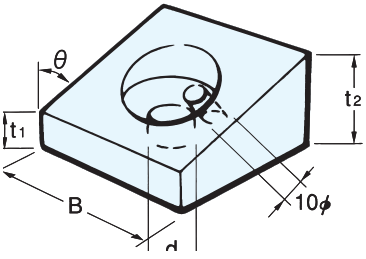

Nominal diameter	B	d	t ₁	t ₂
17	90	20		
19.3	120	23		
21.8	135	26		
23	120	27		
26	135	30		
33	165	36		

Production on order

How to Use

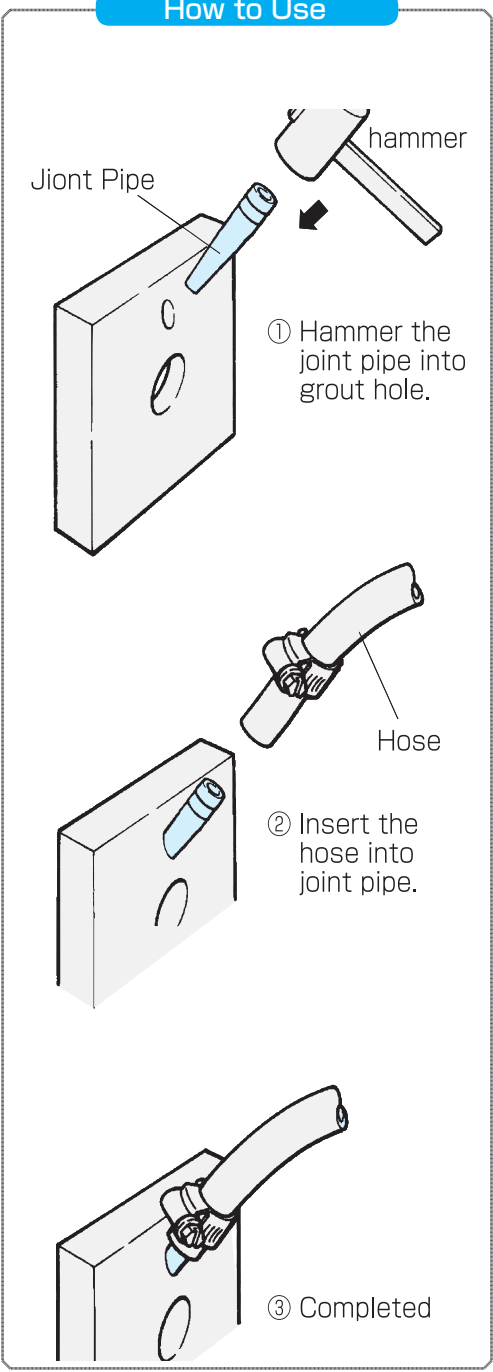

Spiral Rod (order made product)

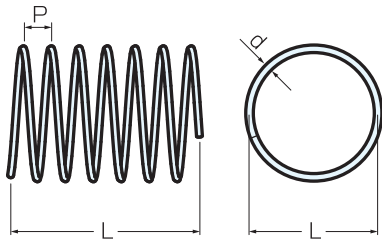

(Unit: mm)

D	P	L	d (φ)
120	50	300	9
280	60	400	13
390	65	540	16

· It is available to be made by deformed bar as per request.
 · Above length are based on center-to-center.

Grid Rod (order made product)

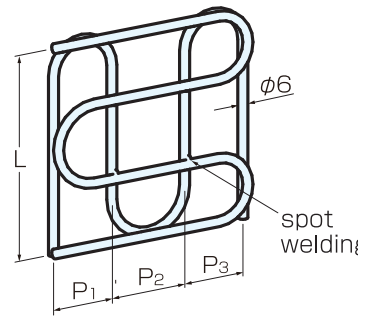

(Unit: mm)

W rod	ℓ	P ₁	P ₂	P ₃
100	100	30	40	30
130	130	40	50	40
160	160	50	60	50

· It is available to be made by deformed bar as per request.
 · Above length are based on center-to-center.

Norodomekun PAT.(for steel bridge)

Product Features

- Protect the gap between concrete surface and flange.
- Produce the boundary line to install mold.
- Prevent leakage of lime wash.
- Protect a coating film around flange.

Type 3

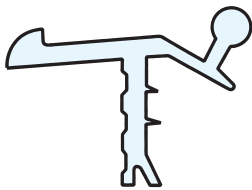

Part code	Material	Color	Length
Type3	Soft PVC	Gray	1.5m



Component for cylindrical form of bridge PAT.

Product feature and application

●Conventional method of using high nut with full thread takes time to after treatment. But by using this product, we use pipe instead of high nut, concrete bar instead of full thread. Insert the concrete bar into pipe and smash them by hammer after measuring that made it easy for after treatment, and also reduce the cost.

●The concrete bar also can be used for other application.

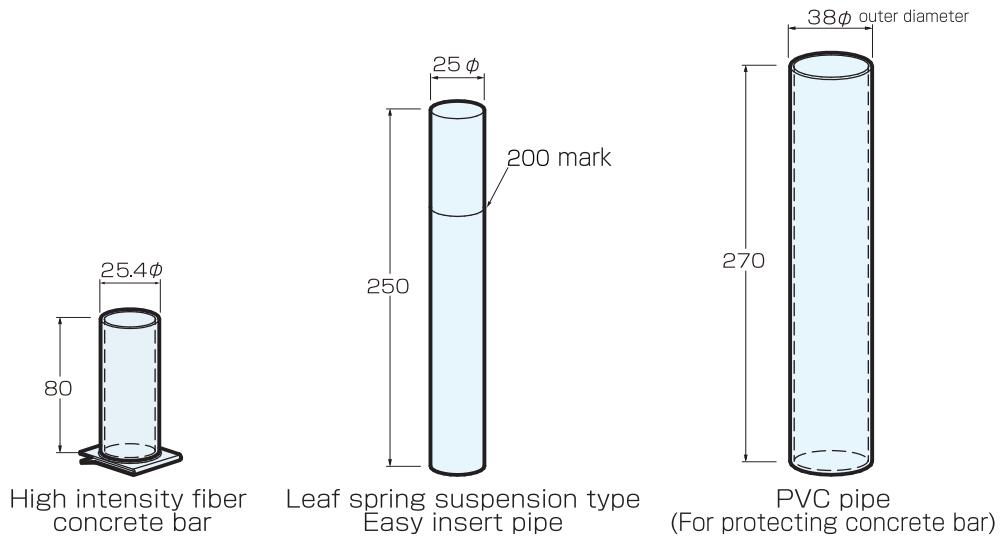

Product feature and application

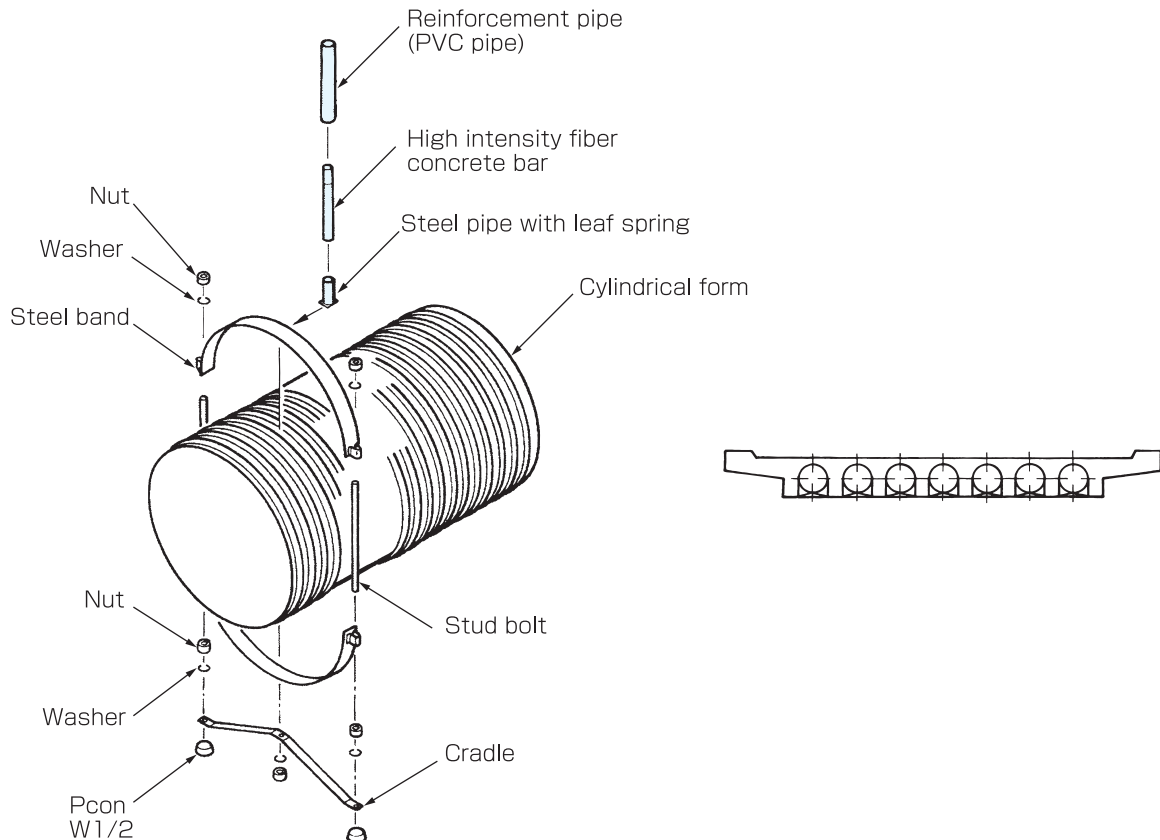

Anchor Plate

Anchor Plate
(Retrofit type)

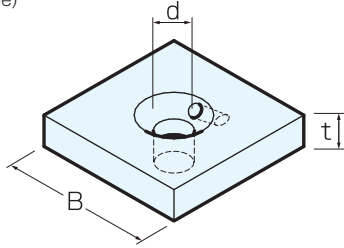

《Oblique type anchor plate and the plate with pipe is also available.》

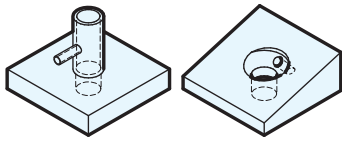

Anchor plate w/pipe Oblique type anchor plate

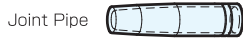

Joint Pipe

Nominal	specification		
	A(B)	t	d
9.2	50	10	11
11	60	12	13
13	70	14	15.5
15	80	16	18
17	90	19	20
*17.8	120	25	23
19	100	19	22
*19.3	120	25	23
21	110	22	25
*21.8	135	28	26
23	120	25	27
26	135	28	30
*28.6	165	32	32
32	165	32	36

※ For stranded wire.
* : If grout hole is required, please specify size of the hole.

PCnut / PCcoupler / PC back nut / PCwasher

PCnut (S45C)

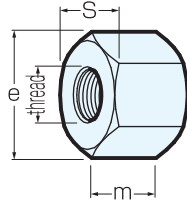

PC coupler (S45C)

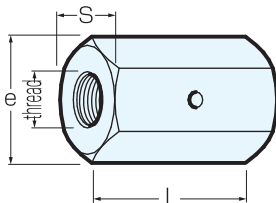

PCback nut (SS400)

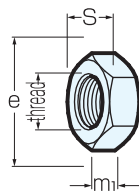

PCwasher (SS400)

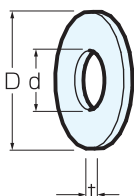

(Unit: mm)

Nominal diameter	thread	pitch	PCnut · PCcoupler				PCback nut			PCwasher		
			S	e	m	L	S	e	m ₁	D	d	t
9.2	M10	1.25	19	21.9	15	35	17	19.6	6	25	10.5	3.2
11	M12	1.5	23	26.6	18	40	19	21.9	7	30	12.5	3.2
13	M14	1.5	26	30.0	21	50	22	25.4	8	32	15.0	3.2
15	M16	1.5	32	37.0	24	55	24	27.7	10	40	17.0	3.2
17	M18	1.5	35	40.4	27	60	27	31.2	11	44	19.0	3.2
19	M20	1.5	38	43.9	30	70	30	34.6	12	48	21.0	3.2
21	M22	2.0	41	47.3	33	75	32	37.0	13	52	23.5	3.2
23	M24	2.0	46	53.1	36	80	36	41.6	14	58	25.5	4.5
26	M27	2.0	50	57.7	40	90	41	47.3	16	62	28.5	4.5
30	M30	2.0	54	62.2	45	100	46	53.1	18	68	31.5	4.5
32	M33	2.0	58	67.0	49	110	50	57.7	20	72	34.5	4.5



Japan Life Co., Ltd.
ジャパンライフ株式会社
<http://www.japanlife.co.jp>